

SURVEYOR'S RECORD

Section 32

Township 108

Range 41

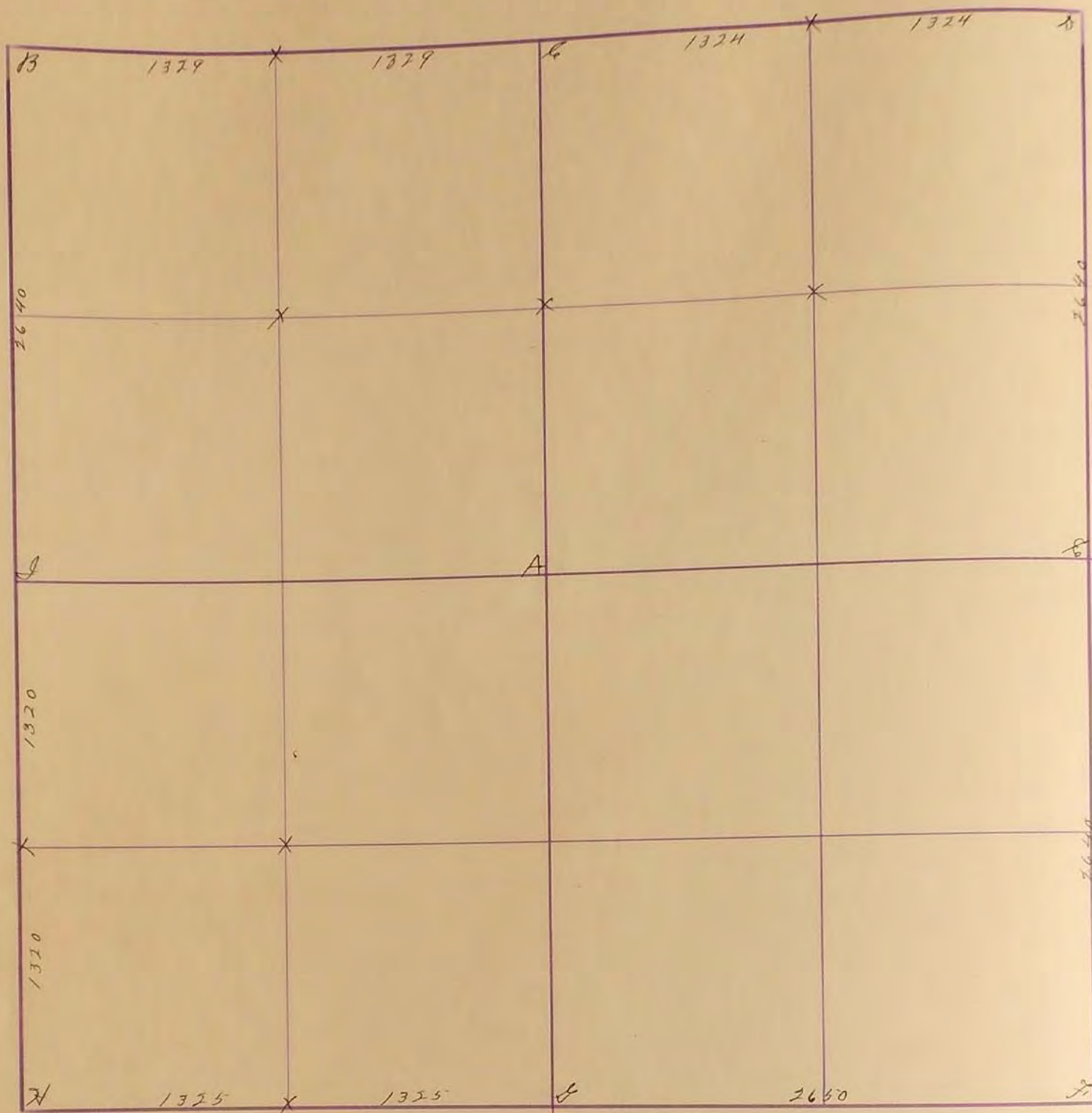

June 3-1907

Cor. cor. B.C.A. & H.S.

established E.T. & X.

J.W. Throatline soft

"H" Stone R.P. Tack in cor. fence post 3E. 40³': R.P. Tack in cor. fence post on line west 32⁴'

"I" Stone R.P. Tack in cor. fence post west on line 38⁷': R.P. Tack in fence post NW. 40³'.

"H" Located fieldstone 9" below grade; Placed steel pin above stone; R.P., N&C, Sign Post NE 54.90'; R.P., N&C, R.P., SE 57.30'; R.P., N&C, Sign post SW 54.01'

"I" Located fieldstone 3 1/2' below grade; Placed steel post above stone; R.P., N&C, Cor Post, West on line 53.52'; R.P., N&C, R.P., East 48.18'; R.P. Steel post SW 71.35'

"B" Located large fieldstone 22" below grade Aug. 18, 1972; Placed steel fence post above center stone; R.P., N&C, R.P., SE. 63.22'; R.P., N&C, Sign post NE. 40.73'; R.P., N&C, TOT, NW. 57.60'

32
33

SURVEY No. 202

Section 32

Town 108

Range 41

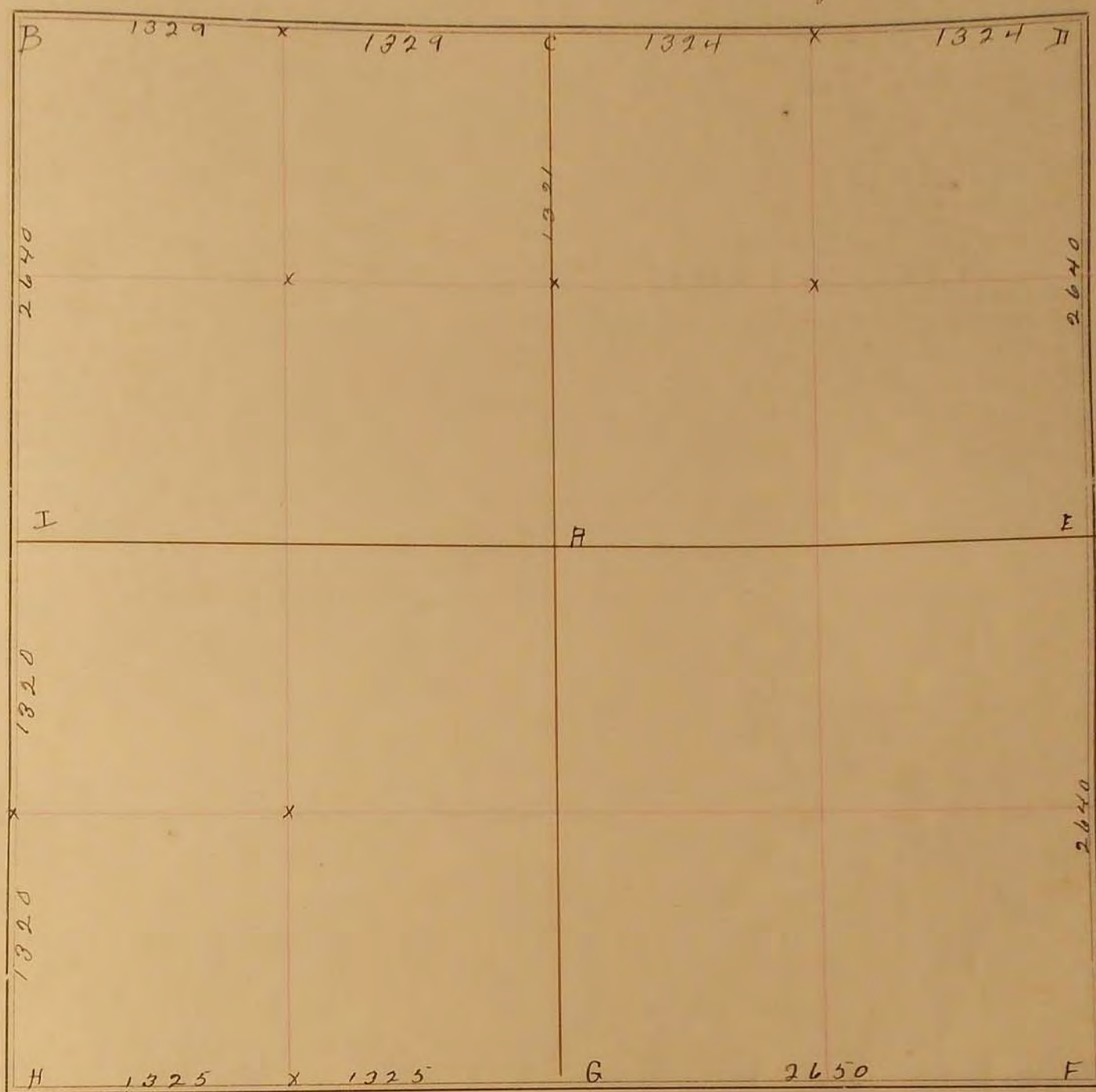

FIELD NOTES.

June, 3, 1907

Gov. Cor. B, C, H, G, H, I.
Established E, F, A, X.

J. W. Woolstenhulme